

Vision System Fanless Embedded Box PC with 6th / 7th Generation Intel® Core™ Desktop Processor and PCIe(x16) + PCIe (x1)

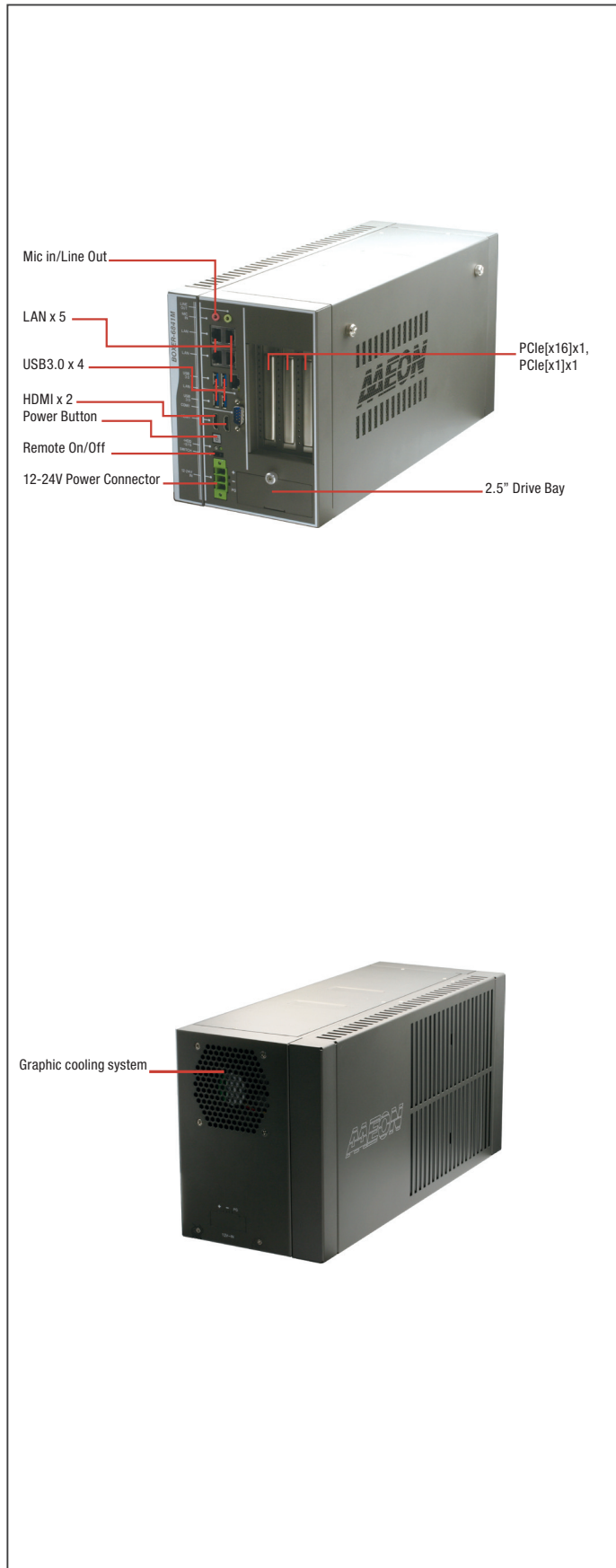

Features

- Support 6th / 7th Core-i desktop processor, Max 65W
- Intel® H110 PCH
- Easy Installation design for expand slot
- Support PCIe[x16] x1, PCIe[x1] x1
- Support up to max 180W Graphic Card
- System Fan with PWM function



Specifications

System	
CPU	Intel Core-i 6th / 7th desktop Processor - Intel Core i7-6700TE, 2.4 GHz - Intel Core i5-6500TE, 2.3 GHz - Intel Core i3-6100TE, 2.7 GHz - Intel Core i7-7700, 3.6 GHz - Intel Core i7-7700T, 2.9 GHz - Intel Core i3-7101TE, 3.4 GHz
Chipset	Intel® H110 PCH
System Memory	DDR4 ECC or Non-ECC SODIMM, up to 32GB
Display Interface	HDMI type A x 2 for HDMI v1.4b
Storage Device	2 x 2.5" Drive Bay
Network	RJ-45 x 5 for GbE (Intel i211AT x4, i219LM x1)
I/O	2 pin Remote Power on/off connector Power ON/OFF Switch x 1 HDMI 1.4b x2 Audio x 2 (MIC-in, Line-out) USB 3.0 x 4 DB-9 x 1 for RS-232/422/485 3 pin DC Power input x 1 (+, -, GND)
Expansion	Full-size Mini card x2 (USB, w/ 1 SIM slot) 1 x PCIe[x16], max support 180W graphic card 1 x PCIe[x1]
Indicator	Power LED x1, HDD active LED x1
OS Support	Skylake S Windows® 10, Windows® 10 IoT, Windows® 8.1, Windows® Embedded Standard 8, Windows® 7, Windows® Embedded Standard 7, Ubuntu 16.04.2 Kabylake Windows® 10, Windows® 10 IoT, Ubuntu 16.04.2
Power Supply	
Power Requirement	DC-In 12-24V - CPU < 65W, No Graphic Card: 120W Adapter - CPU ≤ 65W, 180W Graphic Card: 330W Adapter
Mechanical	
Mounting	Wallmount
Dimensions (W x H x D)	6.10" x 7.87" x 15.75" (155mm x 200mm x 400mm)
Gross Weight	18.29 lb (8.3 Kg)
Net Weight	14.53 lb (7 Kg)
Environmental	
Operating Temperature	-20°C ~ 55°C according to IEC60068-2 with 0.5m/s airflow (TDP 35W Processor)
Storage Temperature	-4°F ~ 176°F (-40°C ~ 80°C)
Storage Humidity	5 ~ 95% @ 40°C, non-condensing
Anti-Vibration	Random, 1Grm, 5~500Hz, Anti-vibration design
Certification	CE/FCC class A

Dimension

Unit: mm

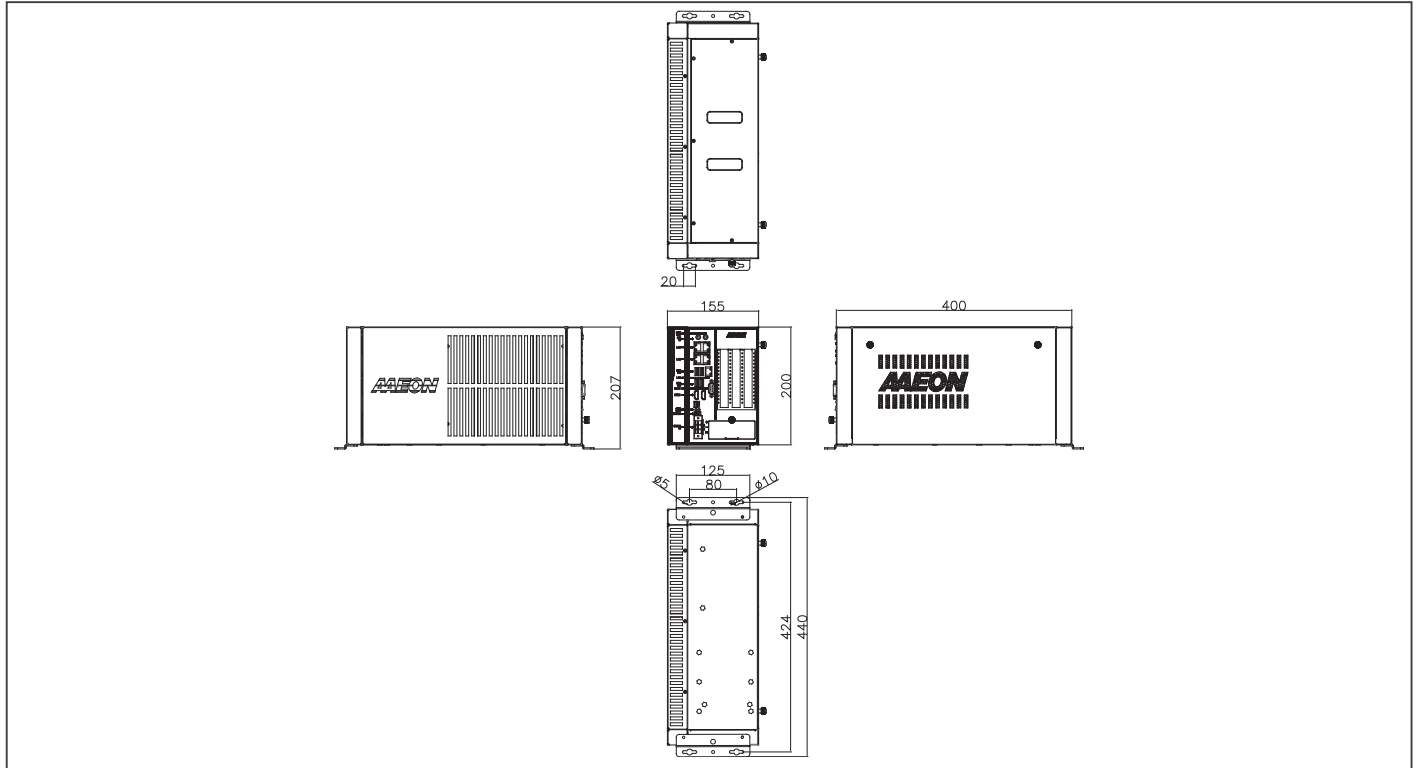

Ordering Information

Part Number	CPU	PCH	LAN	USB 3.0	RS-232/422/485	RS-232	Digital I/O	Audio	Storage	Display	Expansion	Mounting	Power	Operation temp.
BOXER-6841M-A1-1010	—	H110	5	4	1	—	—	MIC-in, Line-out	2.5" Drive Bay x2	HDMI x2	Full-size MiniCard x2, PCIe[x16] x1, PCIe[x1]x1	Wallmount	DC12~24V - CPU < 65W, No Graphic Card: 120W Adapter - CPU ≤ 65W, 180W Graphic Card: 330W Adapter	-20°C ~ 55°C with 0.5m/s airflow (TDP 35W Processor) -20°C ~ 45°C with 0.5m/s airflow (TDP 65W Processor)

Packing List

- Wallmount Bracket x 2
- 3 Pin DC-in Power Connector x 1
- Screw Package x 1
- Thermal Pad Package x 1
- Product DVD
- BOXER-6841M-A1-1010

Optional Accessories

- **1255901209**
120W Power Adapter
- **1255903300**
330W Power Adapter
- **1702031802**
Power Cord (US type)
- **1702031803**
Power Cord (European Type)
- **170203180E**
Power Cord (Japanese Type)
- **9741238H00**
WiFi Module & Antenna
- **9741EC20E0**
4G Module & Antenna (for Europe)
- **9741EC25A0**
4G Module & Antenna (for USA-AT&T)
- **9741EC25V0**
4G Module & Antenna (for USA-Verizon)

Vision System Fanless Embedded Box PC with 6th / 7th Generation Intel® Core™ Desktop Processor and PCIe(x16) + PCIe (x1)

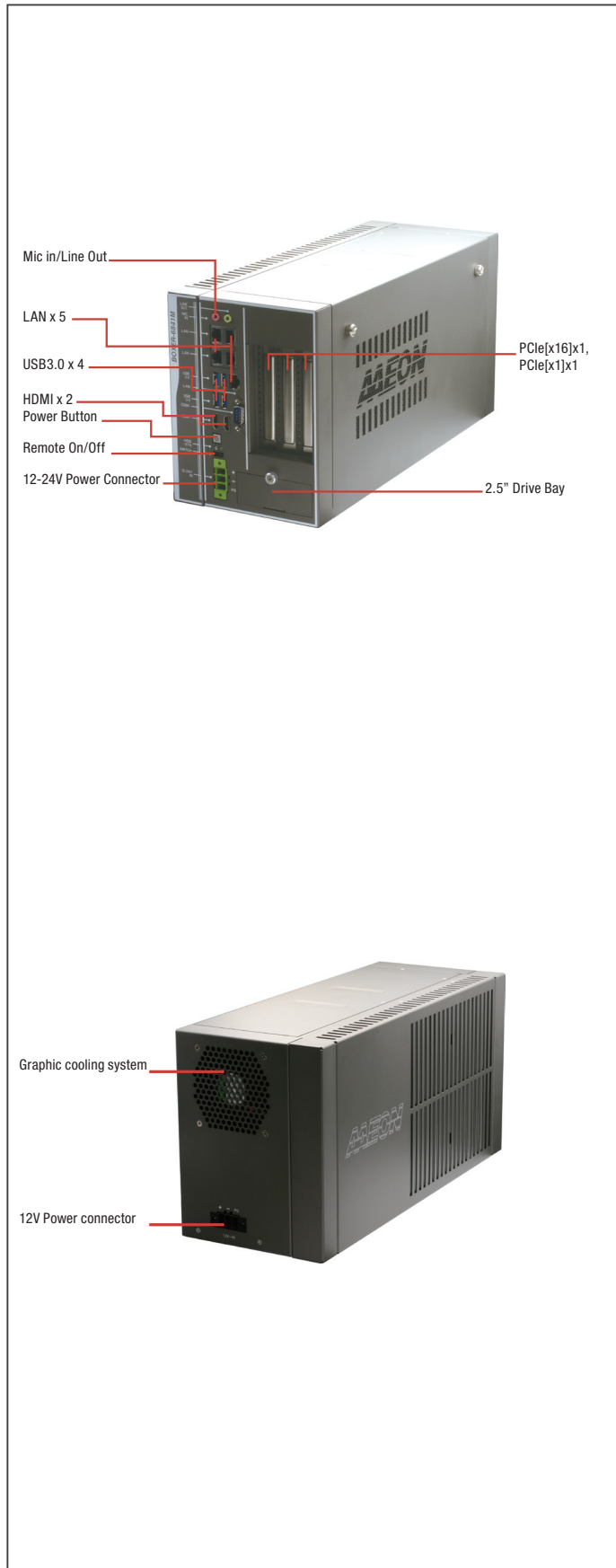

Features

- Support 6th / 7th Core-i desktop processor, Max 65W
- Intel® H110 PCH
- Easy Installation design for expand slot
- Support PCIe[x16] x1, PCIe[x1] x1
- Support up to max 250W Graphic Card
- System Fan with PWM function



Specifications

System	
CPU	Intel Core-i 6th / 7th desktop Processor -Intel Core i7-6700TE, 2.4 GHz -Intel Core i5-6500TE, 2.3 GHz -Intel Core i3-6100TE, 2.7 GHz -Intel Core i7-7700, 3.60 GHz -Intel Core i7-7700T, 2.9 GHz -Intel Core i3-7101TE, 3.4 GHz
Chipset	Intel® H110 PCH
System Memory	DDR4 ECC or Non-ECC SODIMM, up to 32GB
Display Interface	HDMI type A x 2 for HDMI v1.4b
Storage Device	2 x 2.5" Drive Bay
Network	RJ-45 x 5 for GbE (Intel i211AT x4, i219LM x1)
I/O	2 pin Remote Power on/off connector Power ON/OFF Switch x 1 HDMI 1.4b x2 Audio x 2 (MIC-in, Line-out) USB 3.0 x 4 DB-9 x 1 for RS-232/422/485 3 pin DC Power input x 1 (+, -, GND)
Expansion	Full-size Mini card x2 (USB, w/ 1 SIM slot) 1 x PCIe[x16], max support 250W graphic card 1 x PCIe[x1]
Indicator	Power LED x1, HDD active LED x1
OS Support	Skylake S Windows® 10, Windows® 10 IoT, Windows® 8.1, Windows® Embedded Standard 8, Windows® 7, Windows® Embedded Standard 7, Ubuntu 16.04.2 Kabylake Windows® 10, Windows® 10 IoT, Ubuntu 16.04.2
Power Supply	
Power Requirement	DC-In 12~24V For System power, 12V only for Graphic Card - CPU < 65W, No Graphic Card: 120W Adapter - CPU ≤ 65W, 180W < Graphic Card < 250W: 240W Adapter x 2
Mechanical	
Mounting	Wallmount
Dimensions (W x H x D)	6.10" x 7.87" x 15.75" (155mm x 200mm x 400mm)
Gross Weight	18.29 lb (8.3 Kg)
Net Weight	14.53 lb (7 Kg)
Environmental	
Operating Temperature	-20°C ~ 55°C according to IEC60068-2 with 0.5m/s airflow (TDP 35W Processor)
Storage Temperature	-4°F ~ 176°F (-40°C ~ 80°C)
Storage Humidity	5 ~ 95% @ 40°C, non-condensing
Anti-Vibration	Random, 1Grm, 5~500Hz, Anti-vibration design
Certification	CE/FCC class A

Dimension

Unit: mm

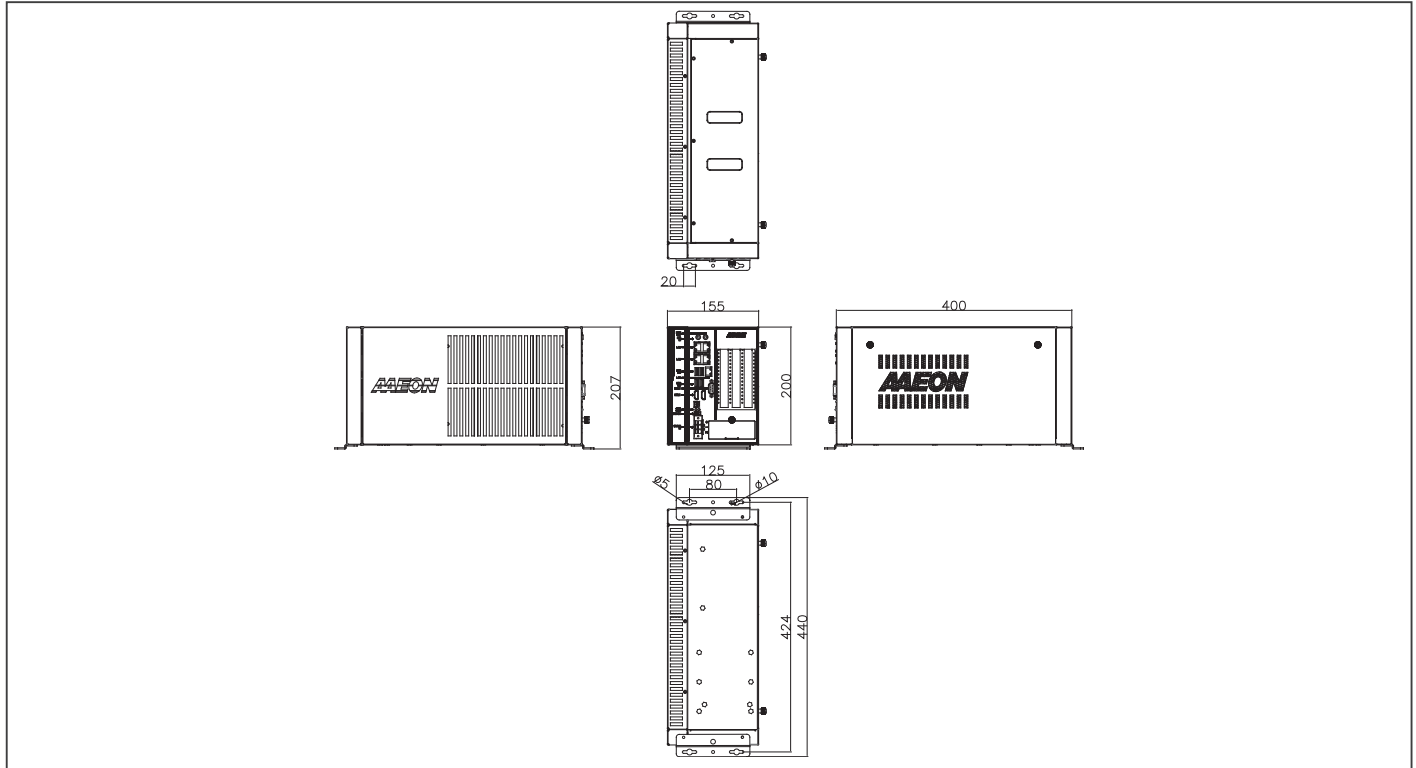

Ordering Information

Part Number	CPU	PCH	LAN	USB 3.0	RS-232/422/485	RS-232	Digital I/O	Audio	Storage	Display	Expansion	Mounting	Power	Operation temp.
BOXER-6841M-A2-1010	—	H110	5	4	1	—	—	MIC-in, Line-out	2.5" Drive Bay x 2	HDMI x 2	Full-size Minicard x2, PCIe[x16] x1, PCIe[x1]x1	Wallmount	DC-In 12~24V For System power, 12V only for Graphic Card - CPU < 65W, No Graphic Card: 120W Adapter - CPU ≤ 65W, 180W < Graphic Card < 250W: 240W Adapter x 2	-20°C ~ 55°C with 0.5m/s airflow (TDP 35W Processor) -20°C ~ 45°C with 0.5m/s airflow (TDP 65W Processor)

Packing List

- Wallmount Bracket x 2
- 3 Pin DC-in Power Connector x 1
- Screw Package x 1
- Thermal Pad Package x 1
- Product DVD
- BOXER-6841M-A2-1010

Optional Accessories

- **1255901209**
120W Power Adapter
- **1255902400**
240W Power Adapter
- **1702031802**
Power Cord (US type)
- **1702031803**
Power Cord (European Type)
- **170203180E**
Power Cord (Japanese Type)
- **9741238H00**
WiFi Module & Antenna
- **9741EC20E0**
4G Module & Antenna (for Europe)
- **9741EC25A0**
4G Module & Antenna (for USA-AT&T)
- **9741EC25V0**
4G Module & Antenna (for USA-Verizon)

Vision System Fanless Embedded Box PC with 6th / 7th Generation Intel® Core™ Desktop / Xeon® server-grade Processor and PCIe(x16) + PCIe (x1)

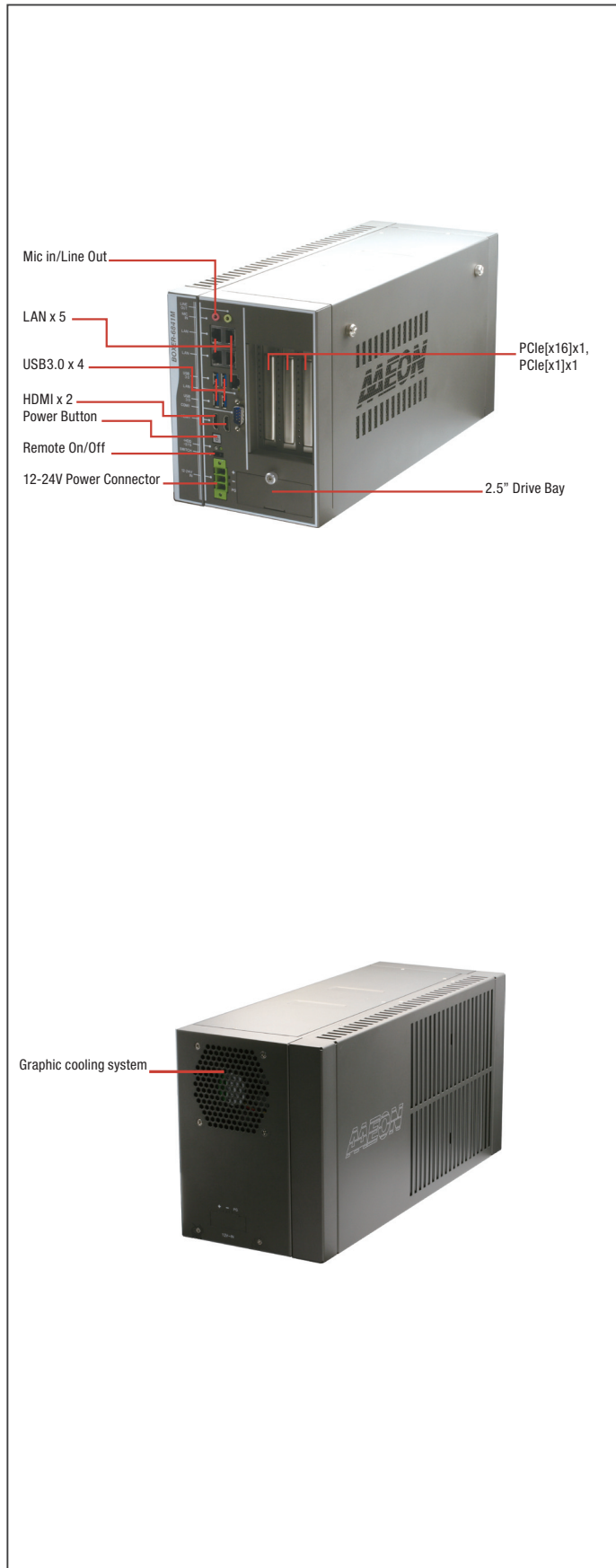

Features

- Support 6th / 7th Core-i desktop and Xeon® server-grade processor, Max 73W.
- Intel® C236 PCH
- Easy Installation design for expand slot
- Support PCIe[x16] x1, PCIe[x1] x1
- Support up to max 180W Graphic Card
- System Fan with PWM function



Specifications

System	
CPU	Intel Core-i 6th / 7th desktop and Xeon® server grade processor -Intel Core i7-6700TE, 2.4 GHz -Intel Core i5-6500TE, 2.3 GHz -Intel Core i3-6100TE, 2.7 GHz -Intel Core i7-7700, 3.6 GHz -Intel Core i7-7700T, 2.9 GHz -Intel Core i3-7101TE, 3.4 GHz Intel Xeon® E3-1268L v5, 2.40 GHz Intel Xeon® E3-1275 v6, 3.80 GHz
Chipset	Intel® C236 PCH
System Memory	DDR4 ECC or Non-ECC SODIMM, up to 32GB
Display Interface	HDMI type A x 2 for HDMI v1.4b
Storage Device	2 x 2.5" Drive Bay
Network	RJ-45 x 5 for GbE (Intel i211AT x4, i219LM x1)
I/O	2 pin Remote Power on/off connector Power ON/OFF Switch x 1 HDMI 1.4b x2 Audio x 2 (MIC-in, Line-out) USB 3.0 x 4 DB-9 x 1 for RS-232/422/485 3 pin DC Power input x 1 (+, -, GND)
Expansion	Full-size Mini card x2 (USB, w/ 1 SIM slot) 1 x PCIe[x16], max support 180W graphic card 1 x PCIe[x1]
Indicator	Power LED x1, HDD active LED x1
OS Support	Skylake S Windows® 10, Windows® 10 IoT, Windows® 8.1, Windows® Embedded Standard 8, Windows® 7, Windows® Embedded Standard 7, Ubuntu 16.04.2 Kabylake Windows® 10, Windows® 10 IoT, Ubuntu 16.04.2
Power Supply	
Power Requirement	DC-In 12~24V - CPU < 73W, No Graphic Card: 120W Adapter - CPU ≤ 73W, 180W Graphic Card: 330W Adapter
Mechanical	
Mounting	Wallmount
Dimensions (W x H x D)	6.10" x 7.87" x 15.75" (155mm x 200mm x 400mm)
Gross Weight	18.29 lb (8.3 Kg)
Net Weight	14.53 lb (7 Kg)
Environmental	
Operating Temperature	-20°C ~ 55°C according to IEC60068-2 with 0.5m/s airflow (TDP 35W Processor) -20°C ~ 45°C according to IEC60068-2 with 0.5m/s airflow (TDP 73W Processor)
Storage Temperature	-4°F ~ 176°F (-40°C ~ 80°C)
Storage Humidity	5 ~ 95% @ 40°C, non-condensing
Anti-Vibration	Random, 1Grm, 5~500Hz, Anti-vibration design
Certification	CE/FCC class A

Dimension

Unit: mm

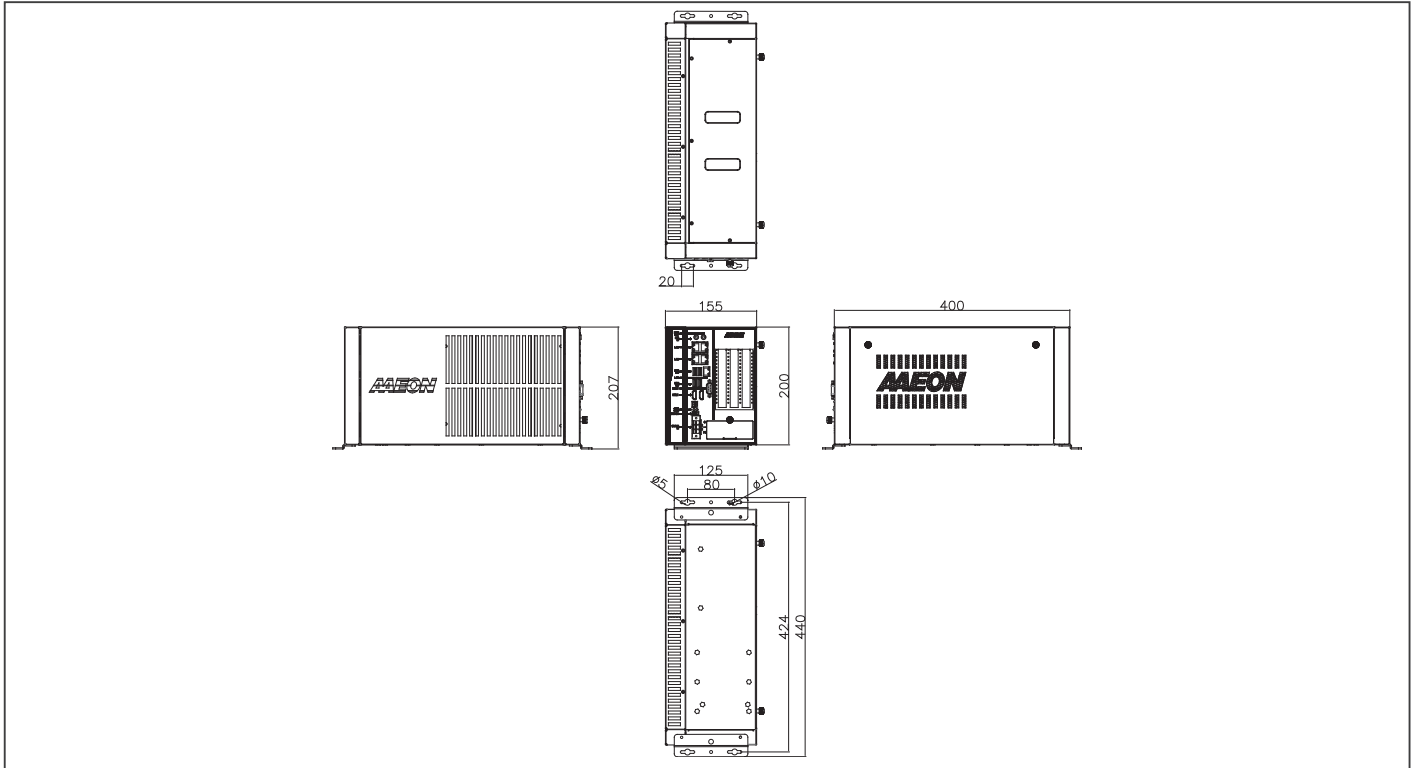

Ordering Information

Part Number	CPU	PCH	LAN	USB 3.0	RS-232/422/485	RS-232	Digital I/O	Audio	Storage	Display	Expansion	Mounting	Power	Operation temp.
BOXER-6841M-A3-1010	—	C236	5	4	1	—	—	MIC-in, Line-out	2.5" Drive Bay x 2	HDMI x2	Full-size Minicard x2, PCIe[x16] x1, PCIe[x1]x1	Wallmount	DC-In 12~24V - CPU < 73W, No Graphic Card: 120W Adapter - CPU ≤ 73W, 180W Graphic Card: 330W Adapter	-20°C ~ 55°C with 0.5m/s airflow (TDP 35W Processor) -20°C ~ 45°C with 0.5m/s airflow (TDP 73W Processor)

Packing List

- Wallmount Bracket x 2
- 3 Pin DC-in Power Connector x 1
- Screw Package x 1
- Thermal Pad Package x 1
- Product DVD
- BOXER-6841M-A3-1010

Optional Accessories

- **1255901209**
120W Power Adapter
- **1255903300**
330W Power Adapter
- **1702031802**
Power Cord (US type)
- **1702031803**
Power Cord (European Type)
- **170203180E**
Power Cord (Japanese Type)
- **9741238H00**
WiFi Module & Antenna
- **9741EC20E0**
4G Module & Antenna (for Europe)
- **9741EC25A0**
4G Module & Antenna (for USA-AT&T)
- **9741EC25V0**
4G Module & Antenna (for USA-Verizon)

Vision System Fanless Embedded Box PC with 6th/7th Generation Intel® Core™ Desktop / Xeon® server-grade Processor and PCIe(x16) + PCIe (x1)

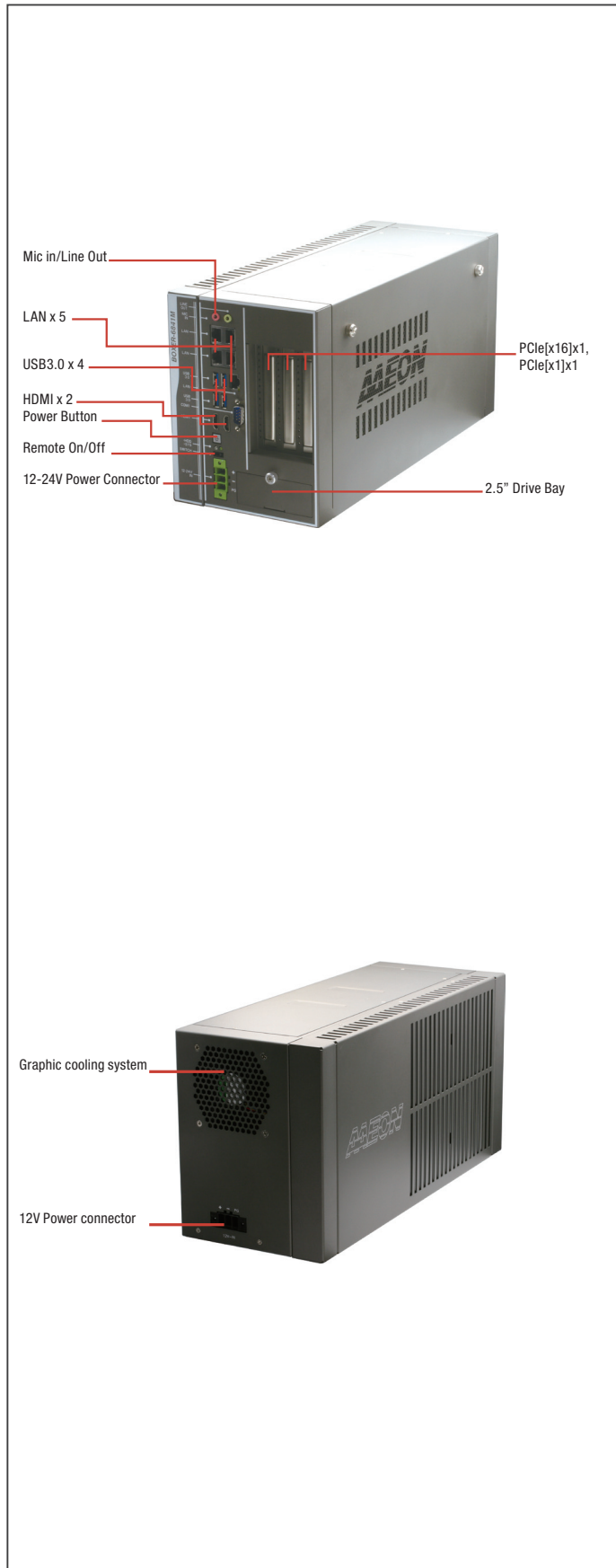

Features

- Support 6th / 7th Core-i desktop and Xeon® server-grade processor, Max 73W.
- Intel® C236 PCH
- Easy Installation design for expand slot
- Support PCIe[x16] x1, PCIe[x1] x1
- Support up to max 250W Graphic Card
- System Fan with PWM function



Specifications

System	
CPU	Intel Core-i 6th / 7th desktop and Xeon® server grade processor -Intel Core i7-6700TE, 2.4 GHz -Intel Core i5-6500TE, 2.3 GHz -Intel Core i3-6100TE, 2.7 GHz -Intel Core i7-7700, 3.6 GHz -Intel Core i7-7700T, 2.9 GHz -Intel Core i3-7101TE, 3.4 GHz -Intel Xeon® E3-1268L v5, 2.40 GHz -Intel Xeon® E3-1275 v6, 3.80 GHz
Chipset	Intel® C236 PCH
System Memory	DDR4 ECC or Non-ECC SODIMM, up to 32GB
Display Interface	HDMI type A x 2 for HDMI v1.4b
Storage Device	2 x 2.5" Drive Bay
Network	RJ-45 x 5 for GbE (Intel i211AT x4, i219LM x1)
I/O	2 pin Remote Power on/off connector Power ON/OFF Switch x 1 HDMI 1.4b x2 Audio x 2 (MIC-in, Line-out) USB 3.0 x 4 DB-9 x 1 for RS-232/422/485 3 pin DC Power input x 1 (+, -, GND)
Expansion	Full-size Mini card x2 (USB, w/ 1 SIM slot) 1 x PCIe[x16], max support 250W graphic card 1 x PCIe[x1]
Indicator	Power LED x1, HDD active LED x1
OS Support	Skylake S Windows® 10, Windows® 10 IoT, Windows® 8.1, Windows® Embedded Standard 8, Windows® 7, Windows® Embedded Standard 7, Ubuntu 16.04.2 Kabylake Windows® 10, Windows® 10 IoT, Ubuntu 16.04.2
Power Supply	
Power Requirement	DC-In 12~24V For System Power, 12V only for Graphic Card - CPU < 73W, No Graphic Card: 120W Adapter - CPU ≤ 73W, 250W Graphic Card: 240W Adapter x 2
Mechanical	
Mounting	Wallmount
Dimensions (W x H x D)	6.10" x 7.87" x 15.75" (155mm x 200mm x 400mm)
Gross Weight	18.29 lb (8.3 Kg)
Net Weight	14.53 lb (7 Kg)
Environmental	
Operating Temperature	-20°C ~ 55°C according to IEC60068-2 with 0.5m/s airflow (TDP 35W Processor) -20°C ~ 45°C according to IEC60068-2 with 0.5m/s airflow (TDP 73W Processor)
Storage Temperature	-4°F ~ 176°F (-40°C ~ 80°C)
Storage Humidity	5 ~ 95% @ 40°C, non-condensing
Anti-Vibration	Random, 1Grm, 5~500Hz, Anti-vibration design
Certification	CE/FCC class A

Dimension

Unit: mm

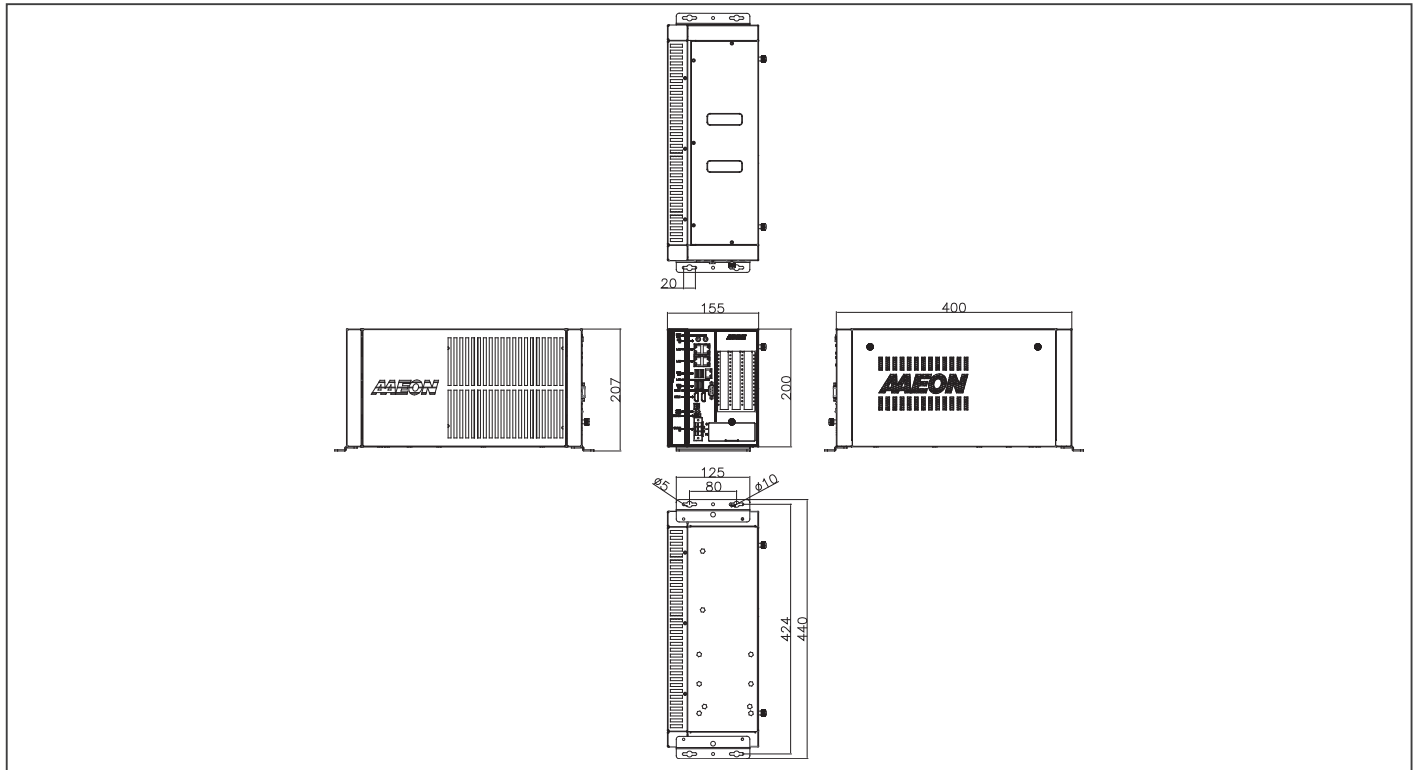

Ordering Information

Part Number	CPU	PCH	LAN	USB 3.0	RS-232/422/485	RS-232	Digital I/O	Audio	Storage	Display	Expansion	Mounting	Power	Operation temp.
BOXER-6841M-A4-1010	—	C236	5	4	1	—	—	MIC-in, Line-out	2.5" Drive Bay x 2	HDMI x2	Full-size Minicard x2, PCIe[x16] x1, PCIe[x1]x1	Wallmount	DC-In 12-24V For System Power, 12V only for Graphic Card - CPU < 73W, No Graphic Card: 120W Adapter - CPU ≤ 73W, 250W Graphic Card: 240W Adapter x 2	-20°C ~ 55°C with 0.5m/s airflow (TDP 35W Processor) -20°C ~ 45°C with 0.5m/s airflow (TDP 73W Processor)

Packing List

- Wallmount Bracket x 2
- 3 Pin DC-in Power Connector x 1
- Screw Package x 1
- Thermal Pad Package x 1
- Product DVD
- BOXER-6841M-A4-1010

Optional Accessories

- **1255901209**
120W Power Adapter
- **1255902400**
240W Power Adapter
- **1702031802**
Power Cord (US type)
- **1702031803**
Power Cord (European Type)
- **170203180E**
Power Cord (Japanese Type)
- **9741238H00**
WiFi Module & Antenna
- **9741EC20E0**
4G Module & Antenna (for Europe)
- **9741EC25A0**
4G Module & Antenna (for USA-AT&T)
- **9741EC25V0**
4G Module & Antenna (for USA-Verizon)

Vision System Fanless Embedded Box PC with 6th/ 7th Generation Intel® Core™ Desktop / Xeon® server-grade Processor and 2 PCIe(x8) + PCIe (x1)

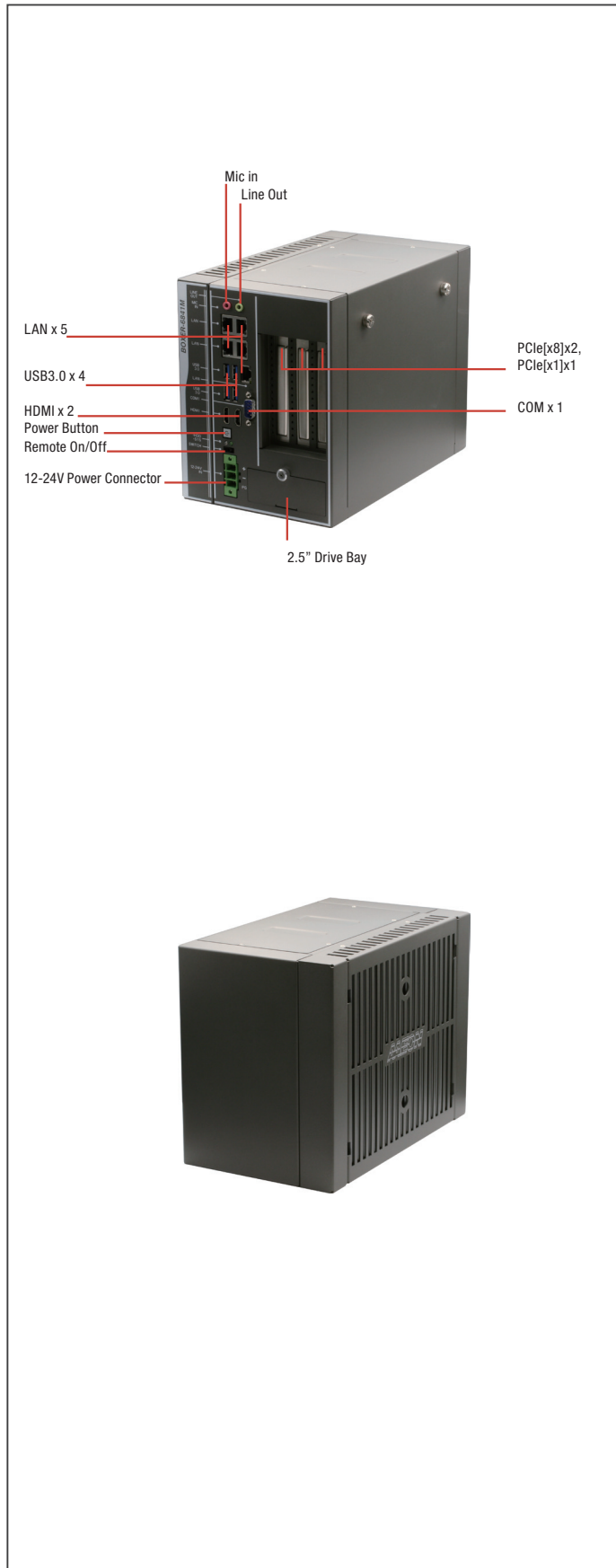

Features

- Support 6th / 7th Core-i desktop and Xeon® server-grade processor, Max 73W.
- Intel® C236 PCH
- Easy Installation design for expand slot
- Support PCIe[x8] x2, PCIe[x1] x1
- Support frame grabber card
- Fanless system



Specifications

System	
CPU	Intel Core-i 6th / 7th desktop and Xeon® server grade processor -Intel Core i7-6700TE, 2.4 GHz -Intel Core i5-6500TE, 2.3 GHz -Intel Core i3-6100TE, 2.7 GHz -Intel Core i7-7700, 3.6 GHz -Intel Core i7-7700T, 2.9 GHz -Intel Core i3-7101TE, 3.4 GHz -Intel Xeon® E3-1268L v5, 2.40 GHz -Intel Xeon® E3-1275 v6, 3.80 GHz
Chipset	Intel® C236 PCH
System Memory	DDR4 ECC or Non-ECC SODIMM, up to 32GB
Display Interface	HDMI type A x 2 for HDMI v1.4b
Storage Device	2 x 2.5" Drive Bay
Network	RJ-45 x 5 for GbE (Intel i211AT x4, i219LM x1)
I/O	2 pin Remote Power on/off connector Power ON/OFF Switch x 1 HDMI 1.4b x2 Audio x 2 (MIC-in, Line-out) USB 3.0 x 4 DB-9 x 1 for RS-232/422/485 3 pin DC Power input x 1 (+, -, GND)
Expansion	Full-size Mini card x2 (USB, w/ 1 SIM slot) PCIEX[8]*2 PCIEX[1]*1
Indicator	Power LED x1, HDD active LED x1
OS Support	Skylake S Windows® 10, Windows® 10 IoT, Windows® 8.1, Windows® Embedded Standard 8, Windows® 7, Windows® Embedded Standard 7, Ubuntu 16.04.2 Kabylake Windows® 10, Windows® 10 IoT, Ubuntu 16.04.2
Power Supply	
Power Requirement	DC-In 12~24V - CPU = 35W: 120W Adapter - 35W < CPU ≤ 73W: 240W Adapter
Mechanical	
Mounting	Wallmount
Dimensions (W x H x D)	6.10" x 7.87" x 10.24" (155mm x 200mm x 260mm)
Gross Weight	12.75 lb (5.8 kg)
Net Weight	9.9 lb (4.5 Kg)
Environmental	
Operating Temperature	-20°C ~ 55°C according to IEC60068-2 with 0.5m/s airflow (TDP 35W Processor) -20°C ~ 45°C according to IEC60068-2 with 0.5m/s airflow (TDP 73W Processor)
Storage Temperature	-4°F ~ 176°F (-40°C ~ 80°C)
Storage Humidity	5 ~ 95% @ 40°C, non-condensing
Anti-Vibration	Random, 1Grm, 5~500Hz, Anti-vibration design
Certification	CE/FCC class A

Dimension

Unit: mm

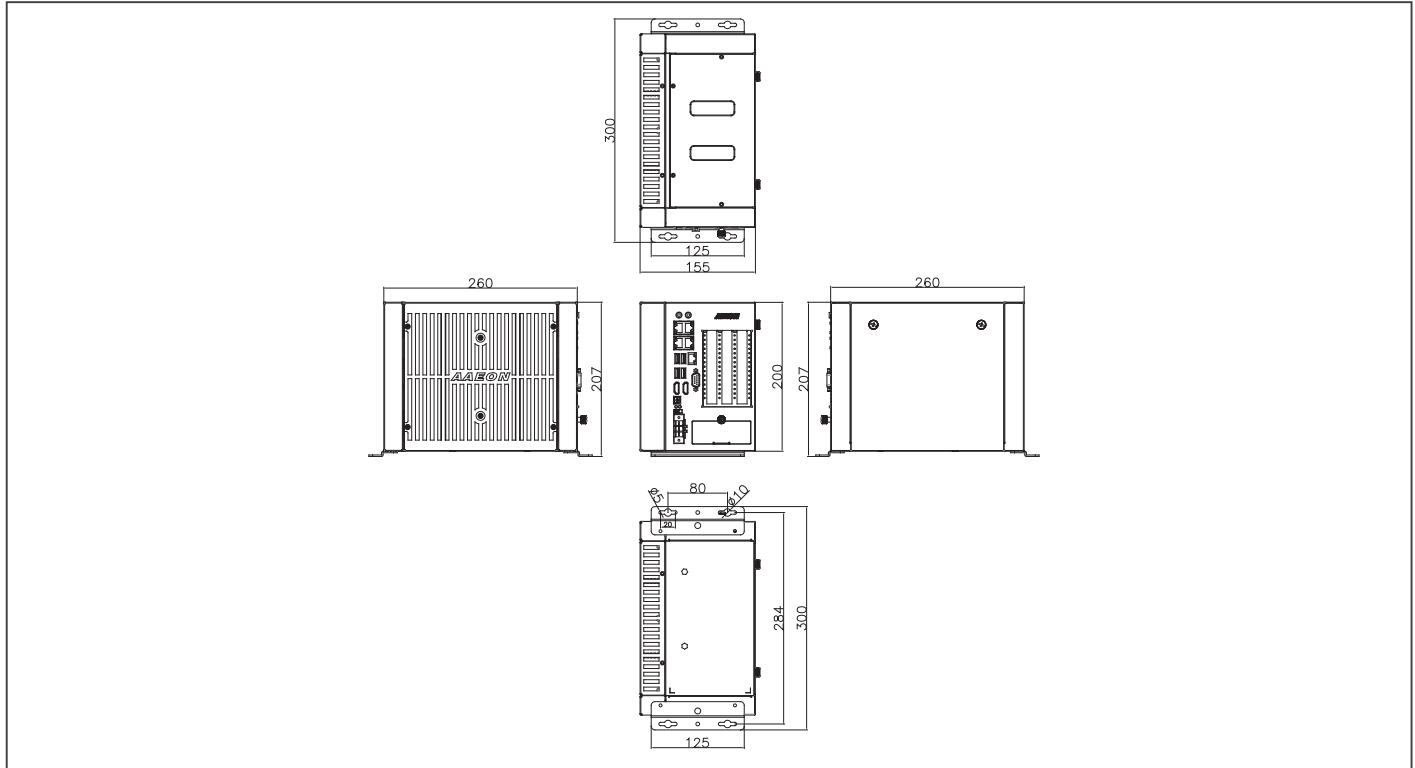

Ordering Information

Part Number	CPU	PCH	LAN	USB 3.0	RS-232/422/485	RS-232	Digital I/O	Audio	Storage	Display	Expansion	Mounting	Power	Operation temp.
BOXER-6841M-A5-1010	—	C236	5	4	1	—	—	MIC-in, Line-out	2.5" Drive Bay x2	HDMI x2	Full-size Minicard x2, PCIe[x8] x2, PCIe[x1]x1	Wallmount	DC-In 12~24V - CPU = 35W: 120W Adapter - 35W < CPU ≤ 73W: 240W Adapter	-20°C ~ 55°C with 0.5m/s airflow (TDP 35W Processor) -20°C ~ 45°C with 0.5m/s airflow (TDP 73W Processor)

Packing List

- Wallmount Bracket x 2
- 3 Pin DC-in Power Connector x 1
- Screw Package x 1
- Thermal Pad Package x 1
- Product DVD
- BOXER-6841M-A5-1010

Optional Accessories

- **1255901209**
120W Power Adapter
- **1255902400**
240W Power Adapter
- **1702031802**
Power Cord (US type)
- **1702031803**
Power Cord (European Type)
- **170203180E**
Power Cord (Japanese Type)
- **9741238H00**
WiFi Module & Antenna
- **9741EC20E0**
4G Module & Antenna (for Europe)
- **9741EC25A0**
4G Module & Antenna (for USA-AT&T)
- **9741EC25V0**
4G Module & Antenna (for USA-Verizon)
- **M046841140**
Main heatsink cover

Vision System Fanless Embedded Box PC with 6th/ 7th Generation Intel® Core™ Desktop / Xeon® server-grade Processor and 2 PCIe(x8) + PCIe (x1)

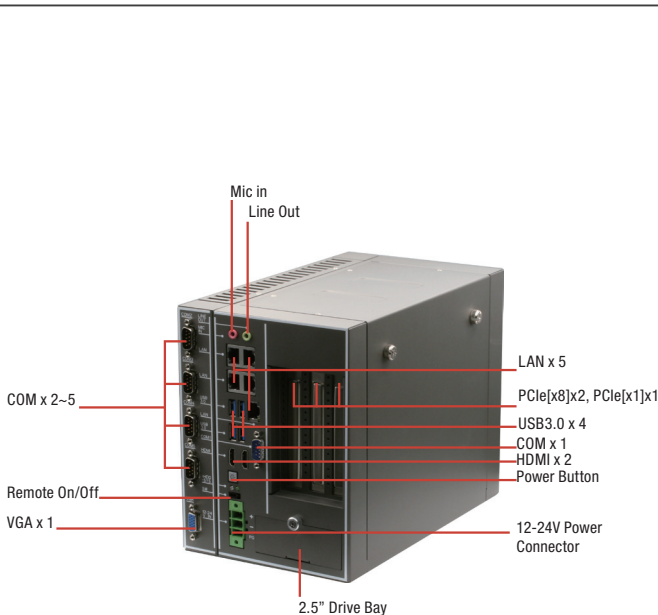

Features

- Support 6th / 7th Core-i desktop and Xeon® server-grade processor, Max 73W.
- Intel® C236 PCH
- Easy Installation design for expand slot
- Support PCIe[x8] x2, PCIe[x1] x1
- Support frame grabber card
- Fanless system
- 5 COM Port and VGA + HDMIx2 Triple display



Specifications

System	
CPU	Intel Core-i 6th / 7th desktop and Xeon® server grade processor -Intel Core i7-6700TE, 2.4 GHz -Intel Core i5-6500TE, 2.3 GHz -Intel Core i3-6100TE, 2.7 GHz -Intel Core i7-7700, 3.6 GHz -Intel Core i7-7700T, 2.9 GHz -Intel Core i3-7101TE, 3.4 GHz -Intel Xeon® E3-1268L v5, 2.40 GHz -Intel Xeon® E3-1275 v6, 3.80 GHz
Chipset	Intel® C236 PCH
System Memory	DDR4 ECC or Non-ECC SODIMM, up to 32GB
Display Interface	HDMI type A x 2 for HDMI v1.4b VGA x 1
Storage Device	2 x 2.5" Drive Bay
Network	RJ-45 x 5 for GbE (Intel i211AT x4, i219LM x1)
I/O	2 pin Remote Power on/off connector Power ON/OFF Switch x 1 HDMI 1.4b x2 VGA x 1 Audio x 2 (MIC-in, Line-out) USB 3.0 x 4 DB-9 x 1 for RS-232/422/485 DB-9 x 4 for RS-232 3 pin DC Power input x 1 (+, -, GND)
Expansion	Full-size Mini card x2 (USB, w/ 1 SIM slot) PCIEx[8]*2 PCIEx[1]*1
Indicator	Power LED x1, HDD active LED x1
OS Support	Skylake S Windows® 10, Windows® 10 IoT, Windows® 8.1, Windows® Embedded Standard 8, Windows® 7, Windows® Embedded Standard 7, Ubuntu 16.04.2 Kabylake Windows® 10, Windows® 10 IoT, Ubuntu 16.04.2
Power Supply	
Power Requirement	DC-In 12~24V - CPU = 35W: 120W Adapter - 35W < CPU ≤ 73W: 240W Adapter
Mechanical	
Mounting	Wallmount
Dimensions (W x H x D)	6.10" x 7.87" x 10.24" (155mm x 200mm x 260mm)
Gross Weight	12.75 lb (5.8 kg)
Net Weight	9.9 lb (4.5 Kg)
Environmental	
Operating Temperature	-20°C ~ 55°C according to IEC60068-2 with 0.5m/s airflow (TDP 35W Processor) -20°C ~ 45°C according to IEC60068-2 with 0.5m/s airflow (TDP 73W Processor)
Storage Temperature	-4°F ~ 176°F (-40°C ~ 80°C)
Storage Humidity	5 ~ 95% @ 40°C, non-condensing
Anti-Vibration	Random, 1Grm, 5~500Hz, Anti-vibration design
Certification	CE/FCC class A

Dimension

Unit: mm

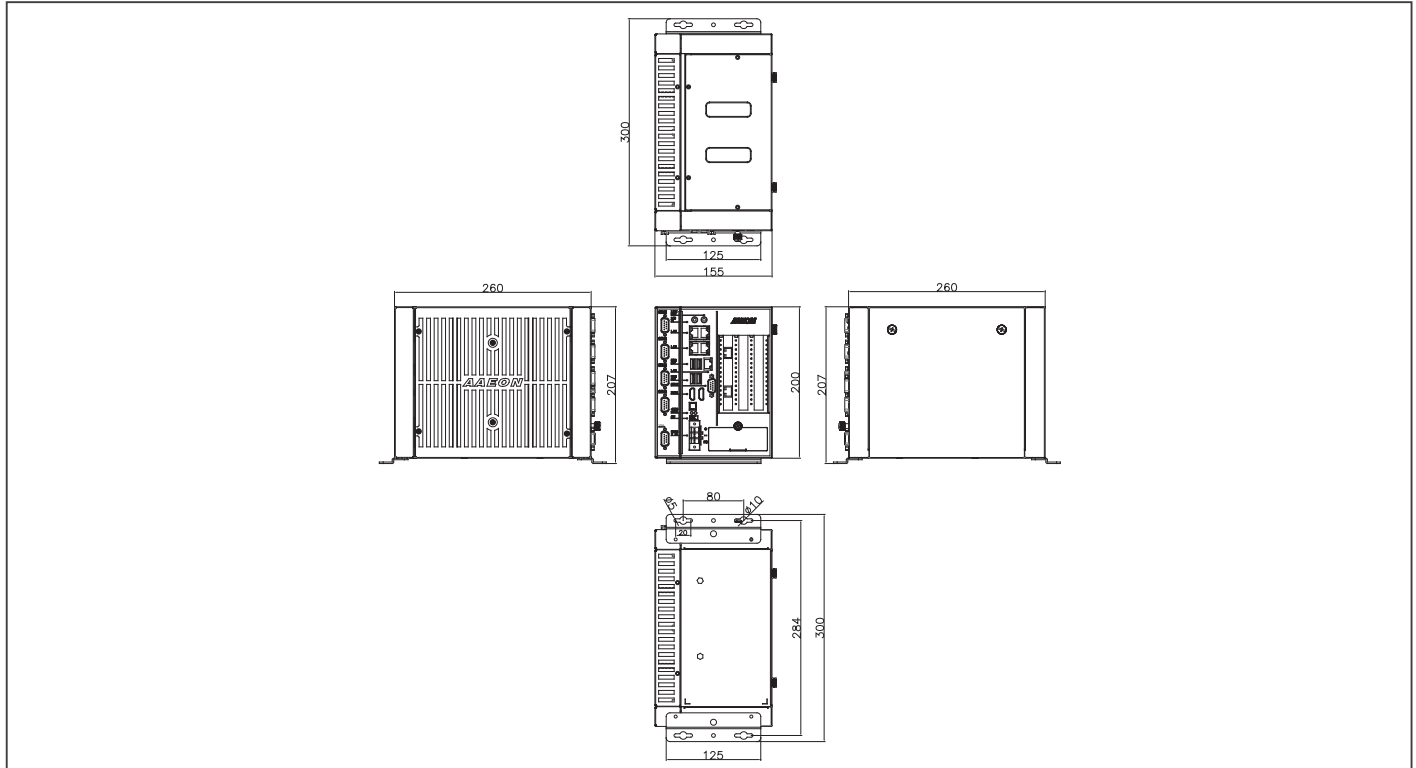

Ordering Information

Part Number	CPU	PCH	LAN	USB 3.0	RS-232/422/485	RS-232	Digital I/O	Audio	Storage	Display	Expansion	Mounting	Power	Operation temp.
BOXER-6841M-A6-1010	—	C236	5	4	1	4	—	MIC-in, Line-out	2.5" Drive Bay x2	HDMI x2, VGA x1	Full-size Minicard x2, PCIe[x8] x2, PCIe[x1]x1	Wallmount	DC-In 12-24V - CPU = 35W: 120W Adapter - 35W < CPU ≤ 73W: 240W Adapter	-20°C ~ 55°C with 0.5m/s airflow (TDP 35W Processor) -20°C ~ 45°C with 0.5m/s airflow (TDP 73W Processor)

Packing List

- Wallmount Bracket x 2
- 3 Pin DC-in Power Connector x 1
- Screw Package x 1
- Thermal Pad Package x 1
- Product DVD
- BOXER-6841M-A6-1010

Optional Accessories

- 1255901209
120W Power Adapter
- 1255902400
240W Power Adapter
- 1702031802
Power Cord (US type)
- 1702031803
Power Cord (European Type)
- 170203180E
Power Cord (Japanese Type)
- 9741238H00
WiFi Module & Antenna
- 9741EC20E0
4G Module & Antenna (for Europe)
- 9741EC25A0
4G Module & Antenna (for USA-AT&T)
- 9741EC25V0
4G Module & Antenna (for USA-Verizon)
- M046841140
Main heatsink cover

Vision System Embedded Box PC with 6th/ 7th Generation Intel® Core™ Desktop / Xeon® server-grade Processor and PCIe[x16] + PCIe [x1]

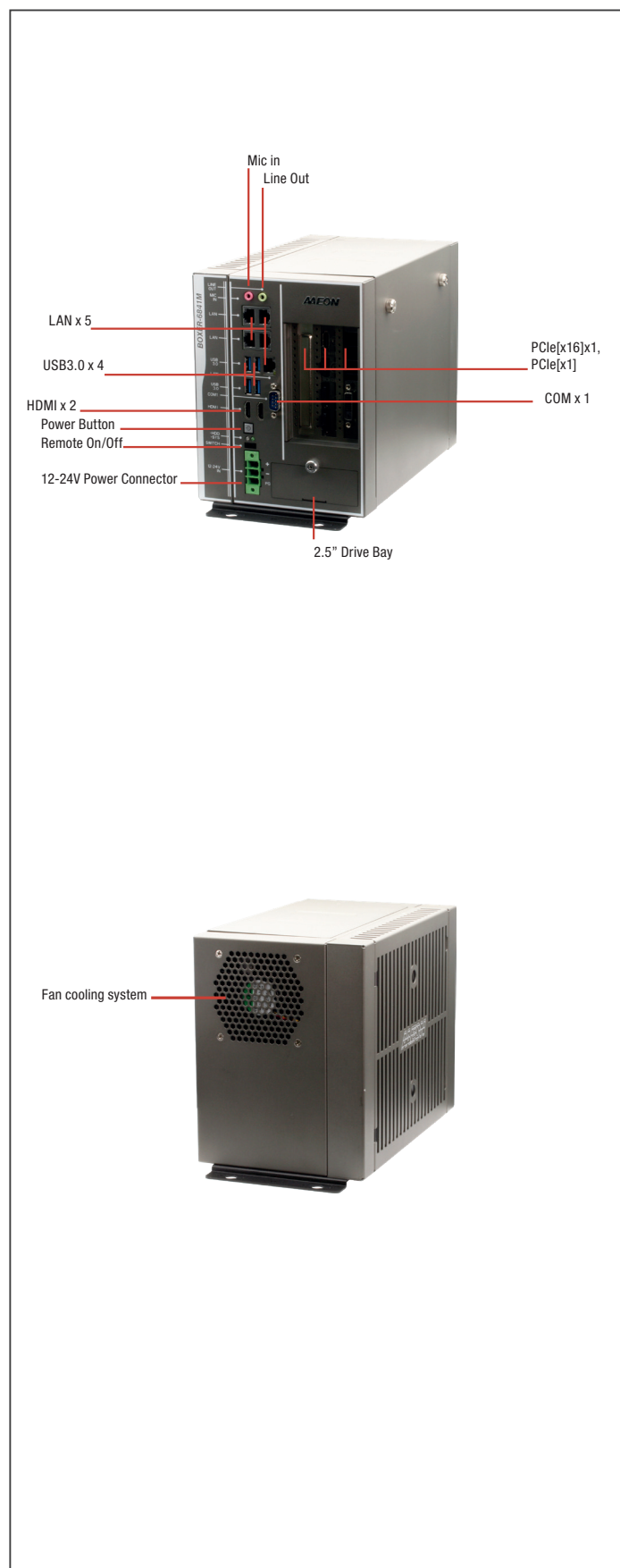

Features

- Support 6th / 7th Core-i desktop and Xeon® server-grade processor, Max 73W.
- Intel® C236 PCH
- Easy Installation design for expand slot
- Support PCIe[x16] x1, PCIe[x1] x1
- System Fan with PWM function
- Fanless system



Specifications

System	
CPU	Intel Core-i 6th / 7th desktop and Xeon® server grade processor -Intel Core i7-6700TE, 2.4 GHz -Intel Core i5-6500TE, 2.3 GHz -Intel Core i3-6100TE, 2.7 GHz -Intel Core i7-7700, 3.6 GHz -Intel Core i7-7700T, 2.9 GHz -Intel Core i3-7101TE, 3.4 GHz -Intel Xeon® E3-1268L v5, 2.40 GHz -Intel Xeon® E3-1275 v6, 3.80 GHz
Chipset	Intel® C236 PCH
System Memory	DDR4 ECC or Non-ECC SODIMM, up to 32GB
Display Interface	HDMI 1.4b
Storage Device	2 x 2.5" Drive Bay
Network	RJ-45 x 5 for GbE (Intel i211AT x4, i219LM x1)
I/O	Audio x 2 (MIC-in, Line-out) RJ-45 x 5 for GbE LAN USB Type A x4 for USB 3.0 DB-9 x1 for RS-232/422/485 HDMI type A x2 for HDMI v1.4b Power ON/OFF Switch x 1 2 pin Remote Power on/off connector x1 Power input x 1
Expansion	Full-size Mini card x2 (USB, w/ 1 SIM slot) 1 x PCIe[x16], max support 180W graphic card - Extension card size limit: 114.55mm(H) x 192mm (L) 1 x PCIe[x1]
Indicator	Power LED x1, HDD active LED x1
OS Support	Skylake S Windows® 10, Windows® 10 IoT, Windows® 8.1, Windows® Embedded Standard 8, Windows® 7, Windows® Embedded Standard 7, Ubuntu 16.04.2 Kabylake Windows® 10, Windows® 10 IoT, Ubuntu 16.04.2
Power Supply	
Power Requirement	DC-In 12-24V - CPU < 73W, No Graphic Card: 120W Adapter - CPU ≤ 73W, 180W Graphic Card: 330W Adapter
Mechanical	
Mounting	Wallmount
Dimensions (W x H x D)	6.10" x 7.87" x 10.24" (155mm x 200mm x 260mm)
Gross Weight	12.75 lb (5.8 kg)
Net Weight	9.9 lb (4.5 Kg)
Environmental	
Operating Temperature	-20°C ~ 55°C according to IEC60068-2 with 0.5m/s airflow (TDP 35W Processor) -20°C ~ 45°C according to IEC60068-2 with 0.5m/s airflow (TDP 73W Processor)
Storage Temperature	-4°F ~ 176°F (-40°C ~ 80°C)
Storage Humidity	5 ~ 95% @ 40°C, non-condensing
Anti-Vibration	Random, 1Grm, 5-500Hz, Anti-vibration design
Certification	CE/FCC class A

Dimension

Unit: mm

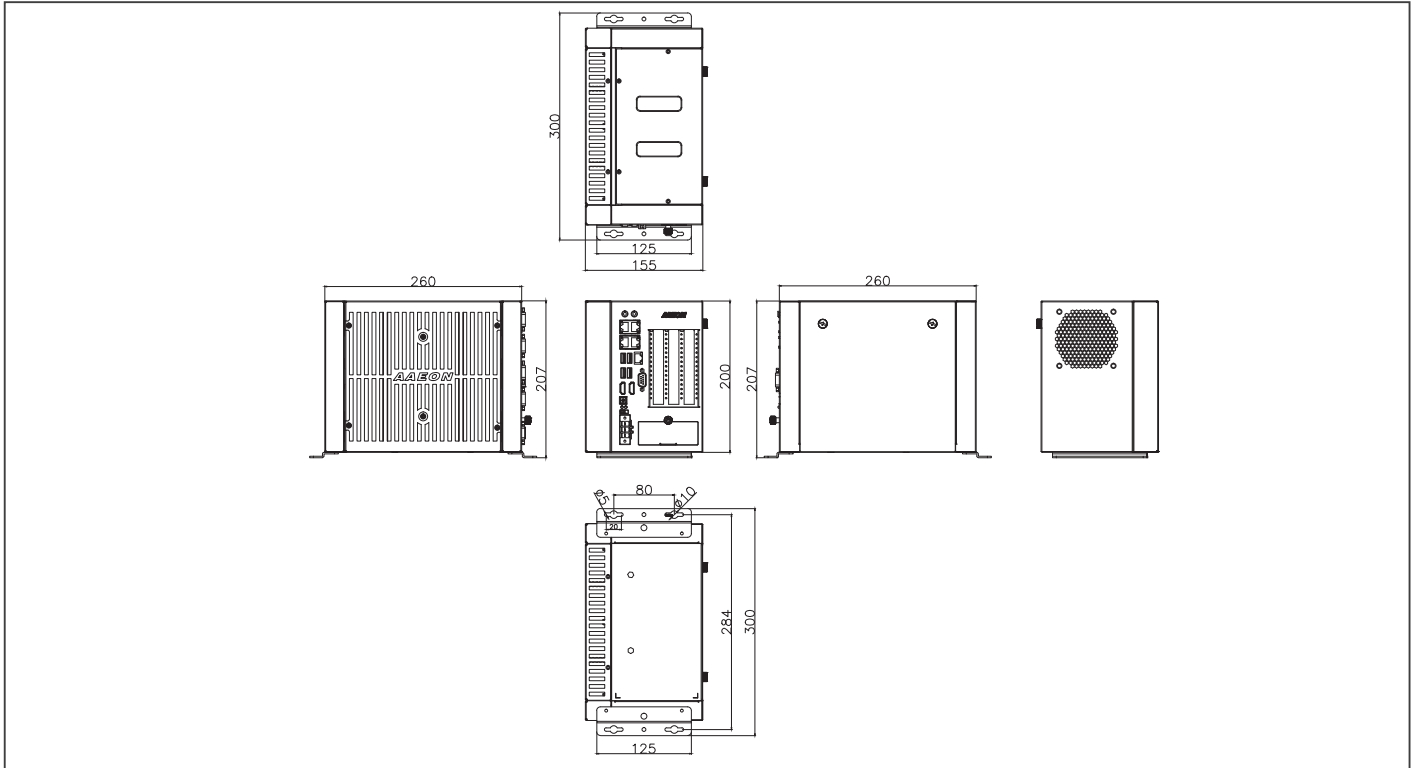

Ordering Information

Part Number	CPU	PCH	LAN	USB 3.0	RS-232/422/485	RS-232	Digital I/O	Audio	Storage	Display	Expansion	Mounting	Power	Operation temp.
BOXER-6841M-A7-1010	—	C236	5	4	1	—	—	MIC-in, Line-out	2.5" Drive Bay x2	HDMI x2	Full-size Minicard x2, PCIe[x16] x 1, PCIe[x1] x 1	Wallmount	DC-In 12-24V - CPU < 73W, No Graphic Card: 120W Adapter - CPU ≤ 73W, 180W Graphic Card: 330W Adapter	-20°C ~ 55°C with 0.5m/s airflow (TDP 35W Processor) -20°C ~ 45°C with 0.5m/s airflow (TDP 73W Processor)

Packing List

- Wallmount Bracket x 2
- 3 Pin DC-in Power Connector x 1
- Screw Package x 1
- Thermal Pad Package x 1
- Product DVD
- BOXER-6841M-A7-1010

Optional Accessories

- **1255901209**
120W Power Adapter
- **1255903300**
330W Power Adapter
- **1702031802**
Power Cord (US type)
- **1702031803**
Power Cord (European Type)
- **170203180E**
Power Cord (Japanese Type)
- **9741238H00**
WiFi Module & Antenna
- **9741EC20E0**
4G Module & Antenna (for Europe)
- **9741EC25A0**
4G Module & Antenna (for USA-AT&T)
- **9741EC25V0**
4G Module & Antenna (for USA-Verizon)
- **M046841140**
Main heatsink cover